

XL³ S 4000

equipment for mounting DCX-M on a plate



XL³ S 4000

equipment for mounting SPX³-V on a busbar



3 390 66



3 390 67

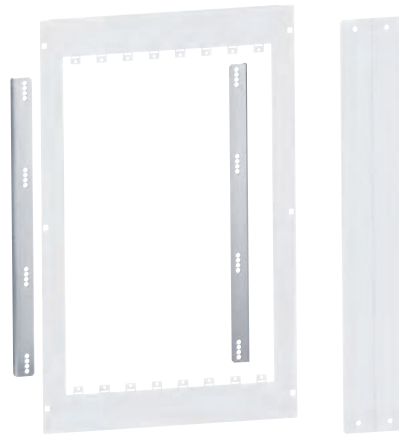

3 394 40

3 394 42

Selection chart p. 344 to 353
Installation principle p. 368

Pack	Cat.Nos	Fixing plates for DCX-M - vertical mounting
1	3 390 64	For DCX-M size 3 - up to 400 A For 24-module enclosure
1	3 390 66	For DCX-M size 4 - up to 800 A For 24-module enclosure
1	3 390 68	For DCX-M size 5 - up to 1250 A For 24-module enclosure
1	3 390 70	For DCX-M size 6 - up to 1600 A For 36-module enclosure

Pack	Cat.Nos	Faceplates for DCX-M - vertical mounting
1	3 390 65	Fixed with 1/4 turn screws or screws For DCX-M size 3 - up to 400 A Height: 300 mm For 24-module enclosure
1	3 390 67	For DCX-M size 4 - up to 800 A Height: 400 mm For 24-module enclosure
1	3 390 69	For DCX-M size 5 - up to 1250 A Height: 700 mm For 24-module enclosure
1	3 390 71	For DCX-M size 6 - up to 1600 A Height: 600 mm For 36-module enclosure

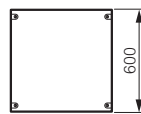
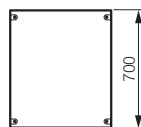
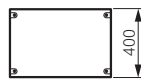
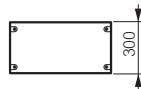

Selection chart p. 344 to 353
Installation principle p. 368

Pack	Cat.Nos	Fixing brackets for SPX ³ -V - insulating supports - horizontal mounting
1	3 394 51	For fixing insulating supports Cat.No 6 058 80 for SPX ³ -V on a busbar and a faceplate For SPX ³ -V - horizontal mounting
1	3 394 54	Faceplates for SPX³-V - horizontal mounting Fixed with 1/4 turn screws or screws For SPX³-V - horizontal mounting Height: 800 For 36-module enclosure
1 1	3 394 40 3 394 41	Fixing kits for SPX³-V - vertical mounting Fixing kits containing: a set of 2 fixing brackets for fixing insulating supports Cat.No 6 058 80 for SPX ³ -V on a busbar and a faceplate Height: 800 mm For 24-module enclosure For 36-module enclosure
1	3 394 42	Blanking plate for SPX³-V faceplate For SPX ³ -V faceplate