

DMX³ 2500 and DMX³-I 2500 - frame 2500

dimensions

Fixed version - frame 2500

Overall dimensions

3P version

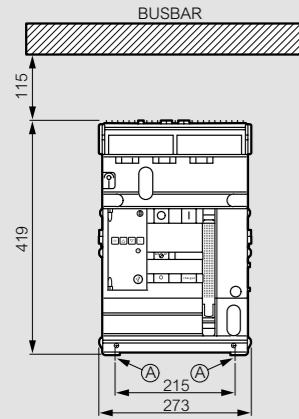

4P version

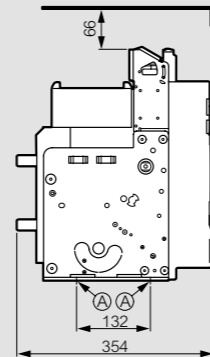
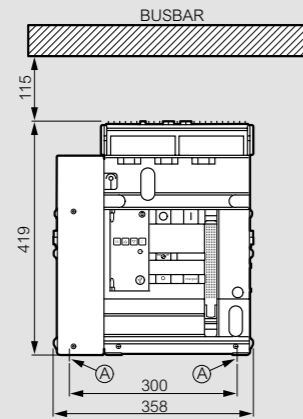

A = fixing point on plate of enclosure

Connection principle

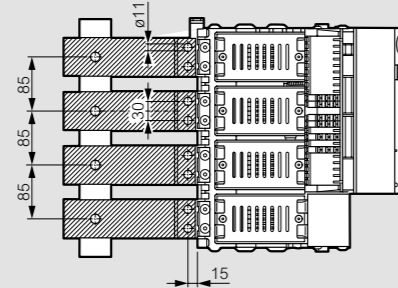
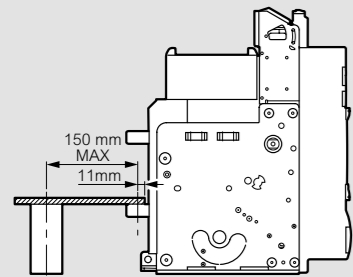

Rear terminals for vertical connection with bars
Cat.Nos 0 288 82/83

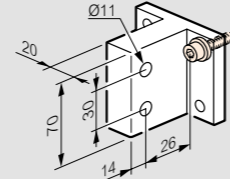

Rear terminals for horizontal connection with bars

3P version

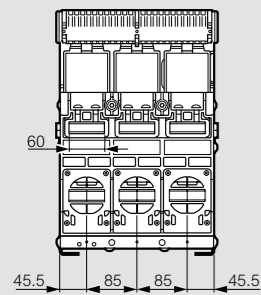

4P version

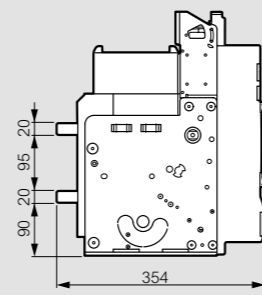
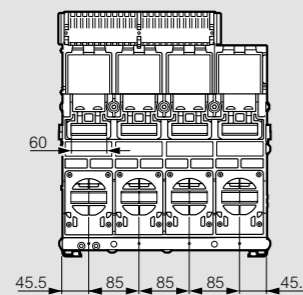

Spreaders for flat connection with bars
Cat.Nos 0 288 86/87

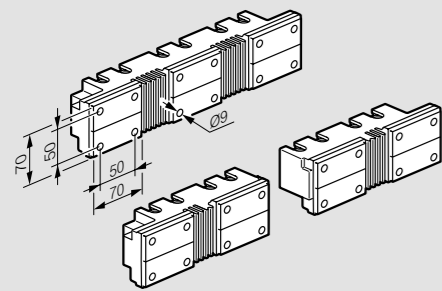

Spreaders for vertical connection with bars
Cat.Nos 0 288 88/89

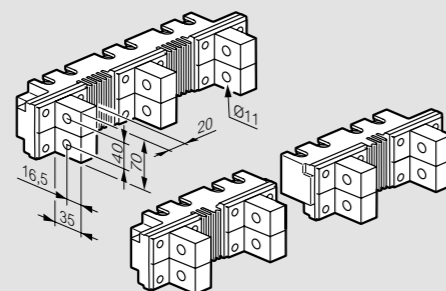

Spreaders for horizontal connection with bars
Cat.Nos 0 288 90/91

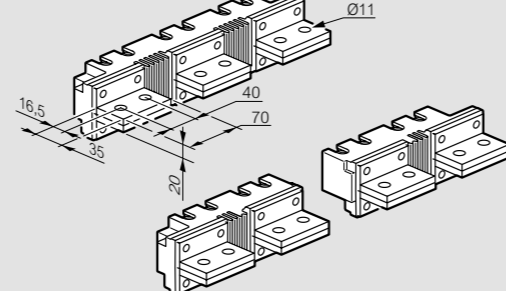

Draw-out version - frame 2500

Overall dimensions

3P version

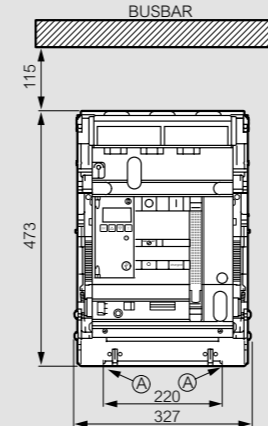

4P version

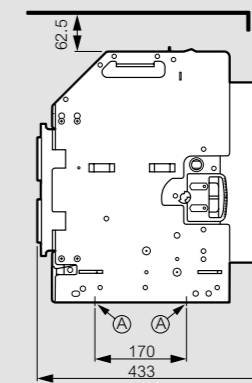
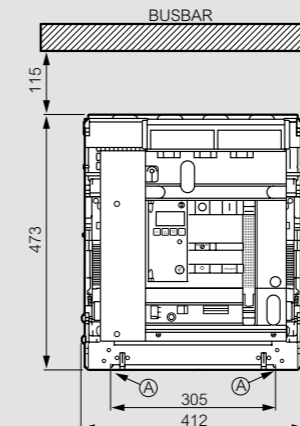

A = fixing point on plate of enclosure

Rear terminals for flat connection with bars

3P version

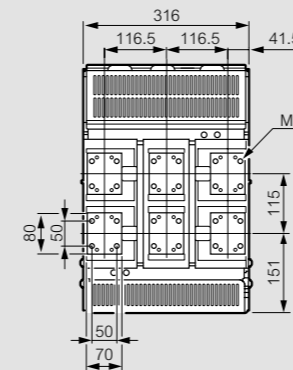

4P version

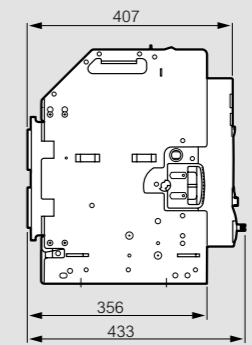
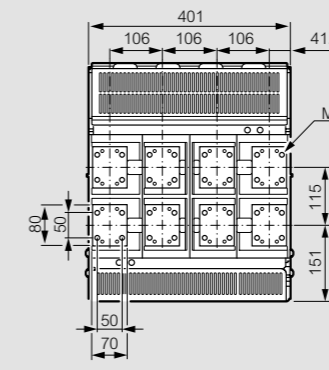

Rear terminals for horizontal connection with bars - Cat.Nos 0 288 96/97

3P version

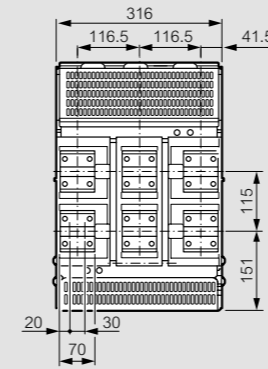

4P version

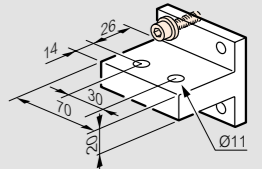
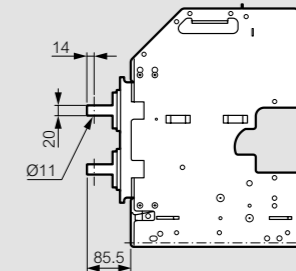
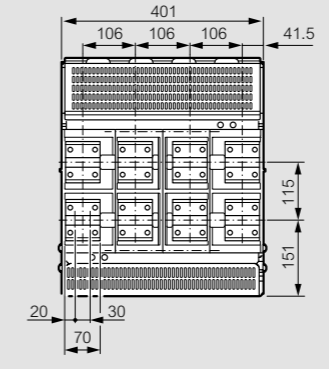

Rear terminals for vertical connection with bars - Cat.Nos 0 288 96/97

3P version

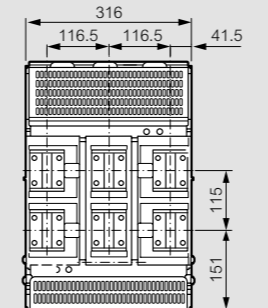

4P version

