

DMX-SP 4000

dimensions

Fixed version - frame 4000

Overall dimensions

3P version

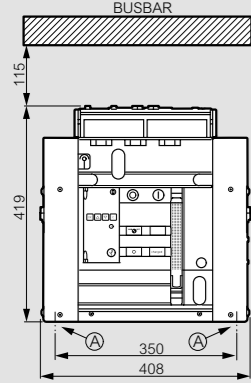

4P version

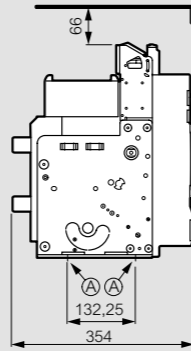
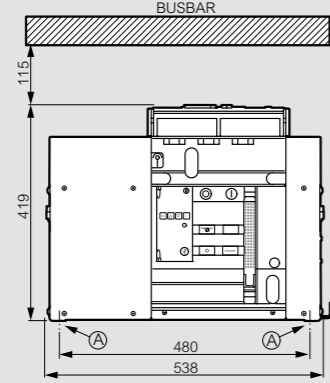

A = fixing point on plate of enclosure

Connection principle

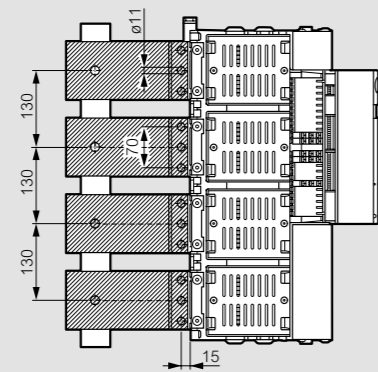
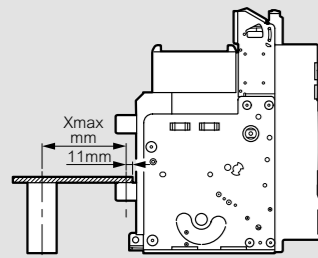

icc (kA)	≤ 50	≤ 65
Xmax (mm)	300	250

Rear terminals for horizontal connection with bars

3P version

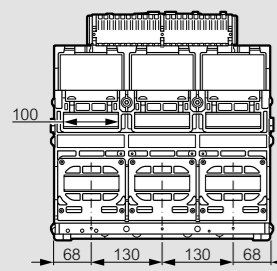

4P version

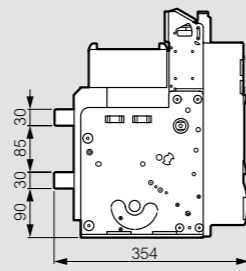
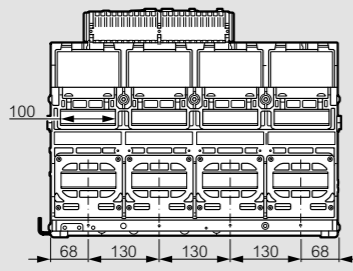

Rear terminals for flat connection with bars

Cat.Nos 6 696 14/15

3P version

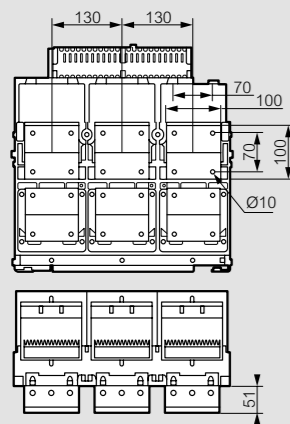

4P version

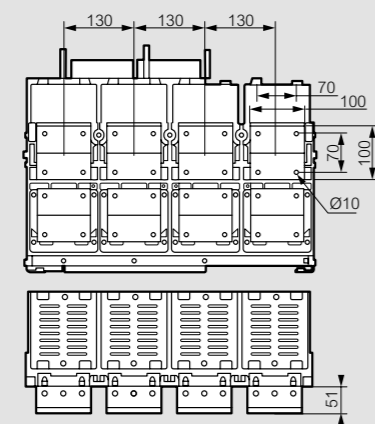

Rear terminals

Cat.Nos 6 696 14/15

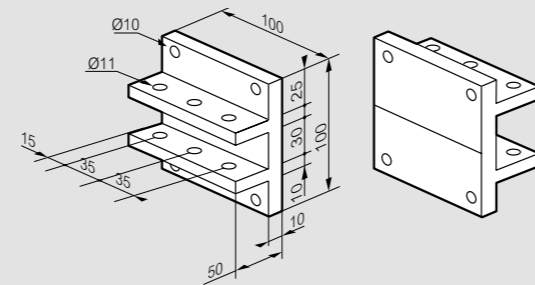

Draw-out version - frame 4000

3P version

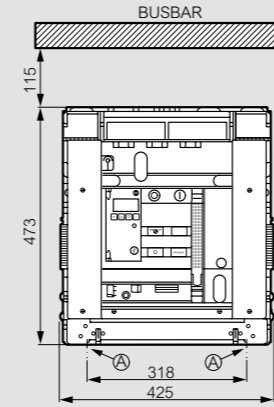

4P version

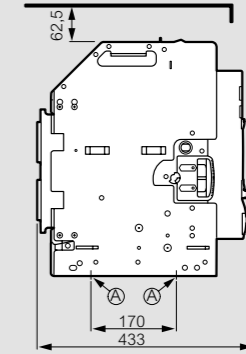
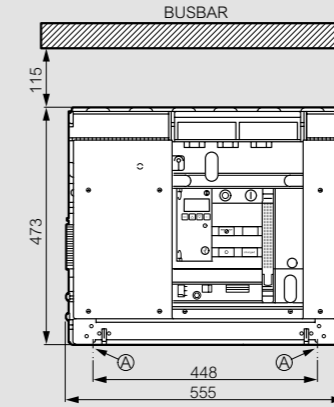

A = fixing point on plate of enclosure

Rear terminals for flat connection with bars

3P version

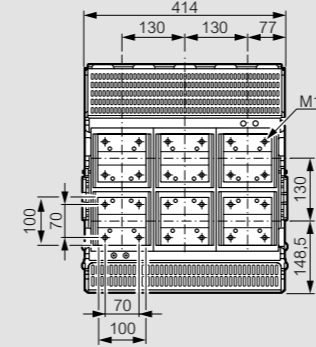

4P version

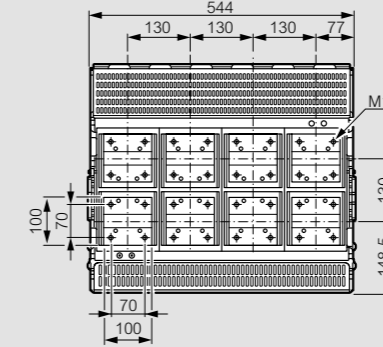

Rear terminals for horizontal connection with bars

Cat.Nos 0 288 94/95

3P version

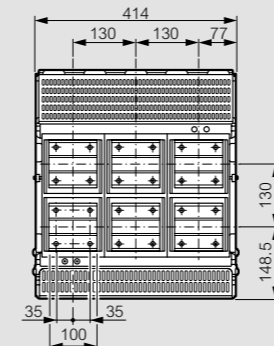

4P version

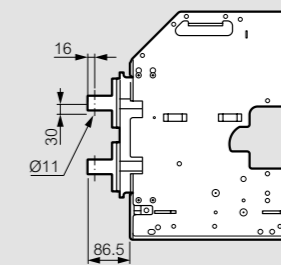
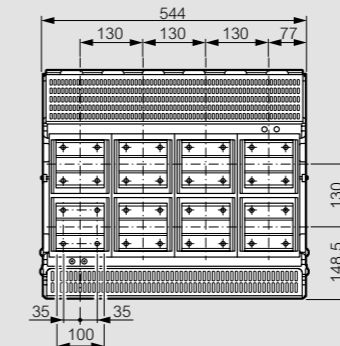

Reversible rear terminals

Cat.Nos 0 288 94/95

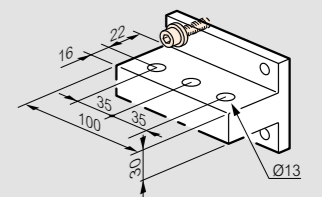

Rear terminals for vertical connection with bars

Cat.Nos 0 288 94/95

3P version

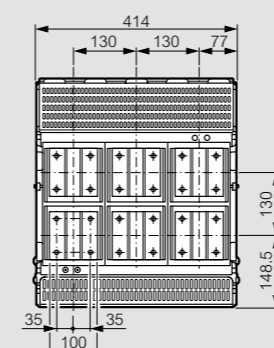

4P version

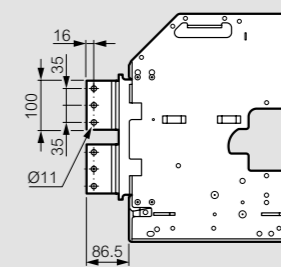
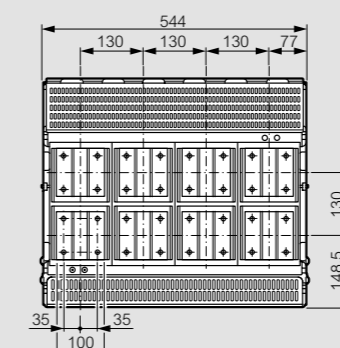

Reversible rear terminals

Cat.Nos 0 288 94/95

