

CX³ and TX³ LED indicators



Pack	Cat.Nos	CX ³ LED indicators	Connection	Number of modules
		Equipped with non replaceable LED lamps LED life: 100 000 h LED consumption: 0.17 W under 230 V~/ 0.11 W under 24 V~ Conform to IEC 60947-5-1 Accept prong-type supply busbars		
		Single - 12/48 V~/=		
10	4 129 21	● Green		1
10	4 129 22	● Red		1
10	4 129 23	● Yellow		1
10	4 129 24	● Blue		1
10	4 129 25	○ White		1
		Single - 110/400 V~		
10	4 129 26	● Green		1
10	4 129 27	● Red		1
10	4 129 28	● Yellow		1
10	4 129 29	● Blue		1
10	4 129 30	○ White		1
		Double - 12/48 V~		
10	4 129 41	●● Green/Red		1
		Double - 110/400 V~		
10	4 129 31	●● Green/Red		1
		Triple - 230/400 V~		
10	4 129 32	○ ○ ○ White		1
10	4 129 33	● ● ● Red		1
10	4 129 34	● ● ● Red/Yellow/Green		1
10	4 129 35	● ● ● Red/Yellow/Blue		1
		TX³ LED indicators - 230 V~		
		Equipped with non replaceable LED lamps		
		Single		
12	6 040 77	● Green		1
12	6 040 78	● Red		1
12	6 040 79	● Orange		1

CX³ changeover and control switches, push-buttons, and LED indicators - technical characteristics

Technical characteristics

Changeover switches

Power dissipation per pole : 1.5 W
Overvoltage category : 4 kV~
Dielectric withstand : 2 kV~
Degree of pollution : 2

Push-buttons and control switches

Electrical endurance : 30 000 cycles AC12
(cos Φ= 0,9) IEC 60947-5-1
Electrical endurance under fluorescent loads : 30 000 cycles according to IEC 60669-1

LED indicators

Equipped with non replaceable LED lamps
LED life : 100 000 h.
LED consumption :
- 0.17 W under 230 V~
- 0.11 W under 24 V~

Dimensions

Changeover switches

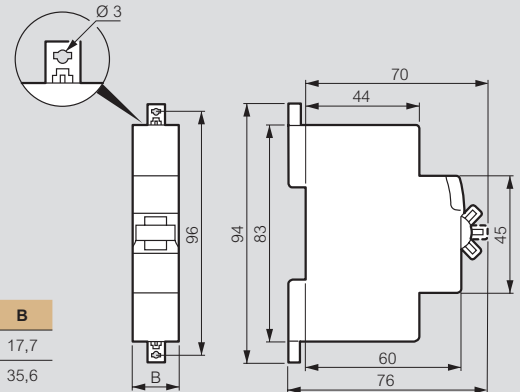

Cat.Nos	B
4 129 00/02/04	17,7
4 129 01/03	35,6

Push-buttons and control switches

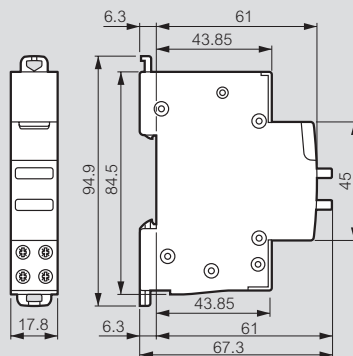

LED indicators

