

Atlantic axis

Exemples d'utilisation

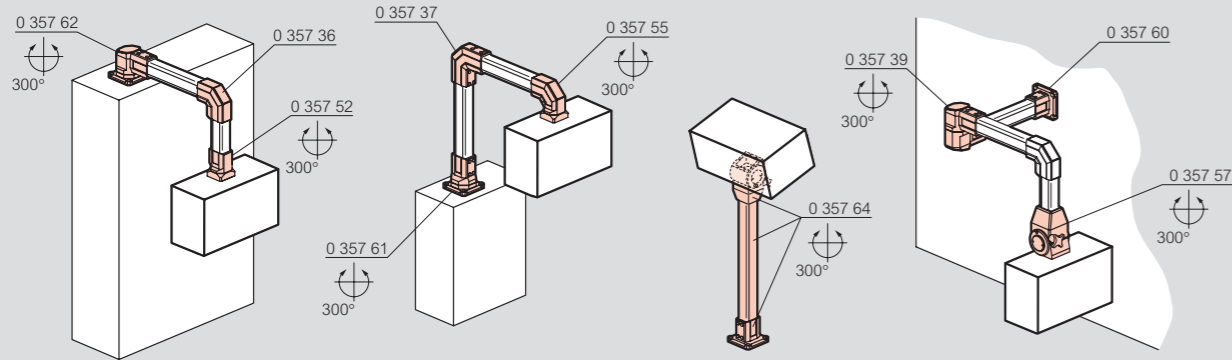

Dimensions (mm)

Positionnement optimal des perçages sur coffret Atlantic pour suspension

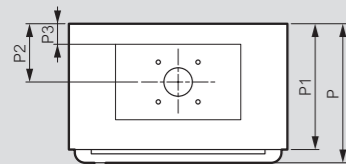

Prof. coffret	Dimensions ajours				P	P1	P2	P3
	Largeur coffret							
	300	400	500	600				
160	-	-	-	-	170	150	-	-
200	-	269 x 115	369 x 115	469 x 115	210	190	88	31
250	-	269 x 115	269 x 115	269 x 115	260	240	106	31

Perçage pour suspension coffret Atlantic

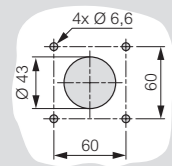

Caractéristiques

Charge admissible sur bras Atlantic axis (poids du coffret inclus)

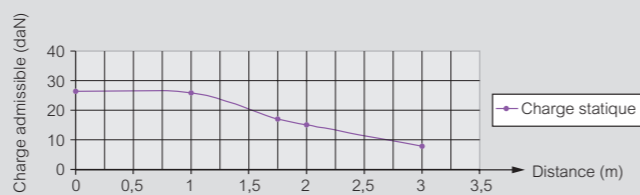

Flèche selon disposition constructive du bras et charge (poids du coffret inclus)

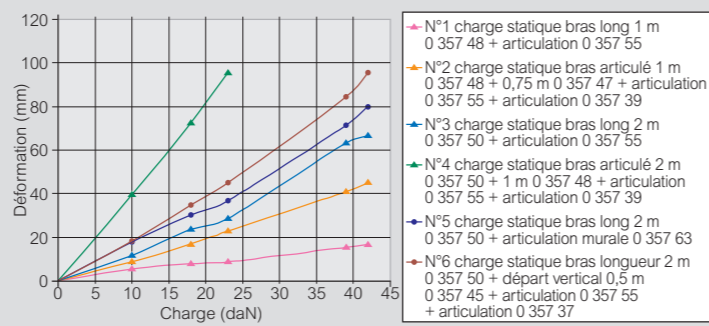

Dimensions et construction du bras articulé

Réf. 0 357 60 - Poids 0,690 kg

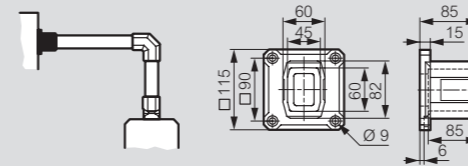

Réf. 0 357 61 - Poids 1,460 kg

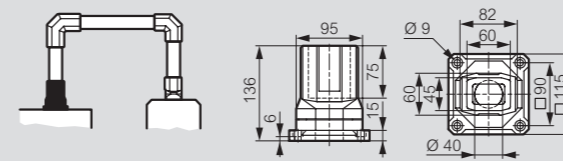

Réf. 0 357 62 - Poids 1,720 kg

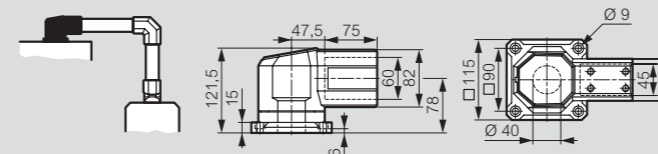

Réf. 0 357 63 - Poids 2,090 kg

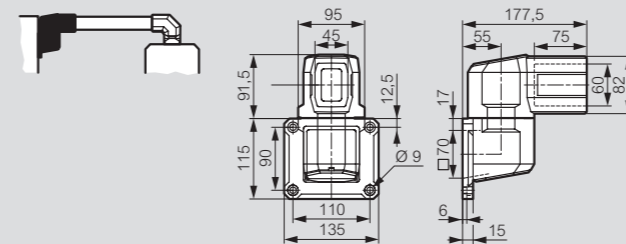

Réf. 0 357 36 - Poids 0,590 kg

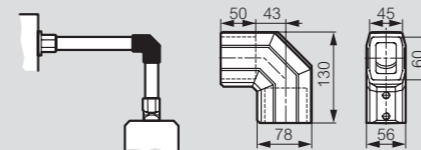

Réf. 0 357 37 - Poids 1,000 kg

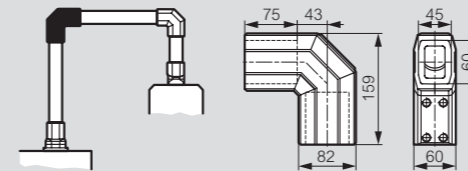

Réf. 0 357 39 - Poids 2,130 kg

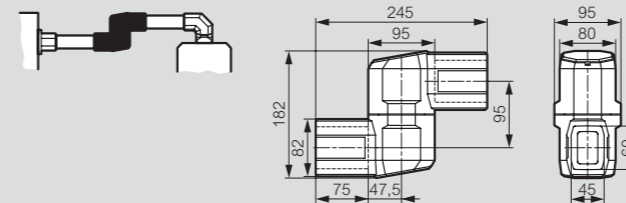

Réf. 0 357 52 - Poids 0,740 kg

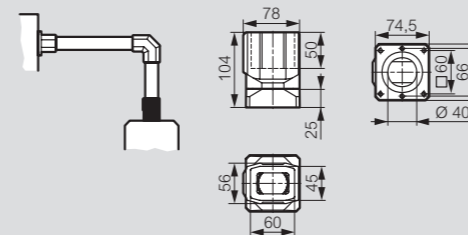

Réf. 0 357 55 - Poids 0,960 kg

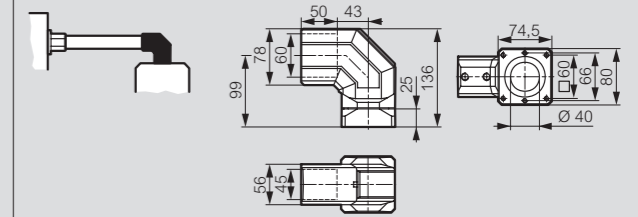

Réf. 0 357 57 - Poids 3,000 kg

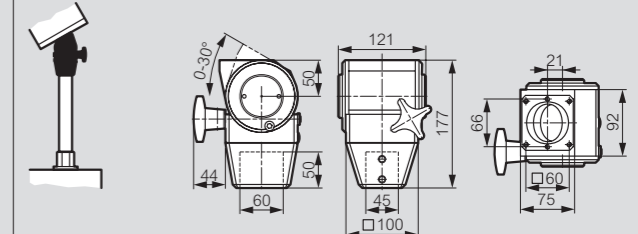

Pied fixe réf. 0 357 64 muni d'un raccord adaptateur d'inclinaison

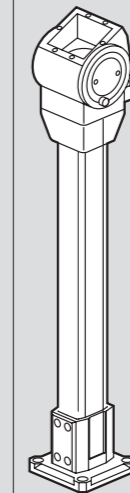

Tube en aluminium réf. 0 357 44/45/48/50

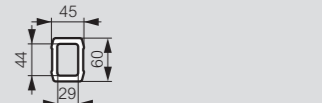

Poignées réf. 0 357 59

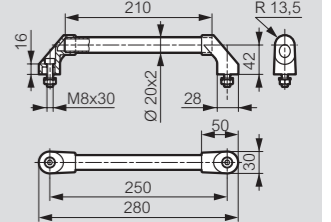

Pied pour console réf. 0 358 74

