

# data cabling accessories - TOH - UDO

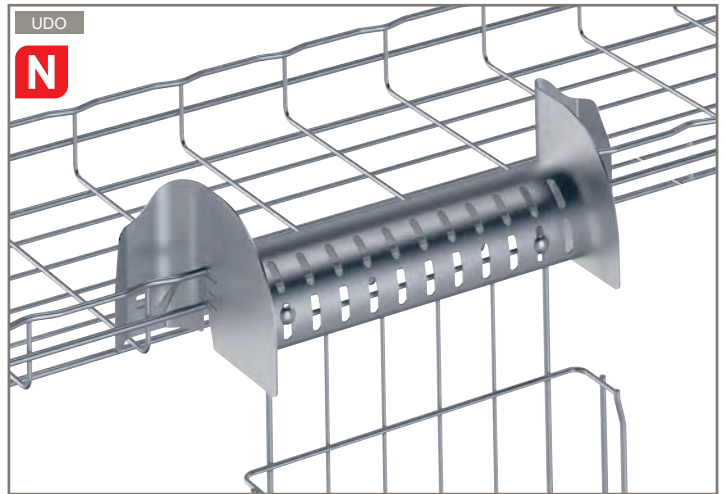
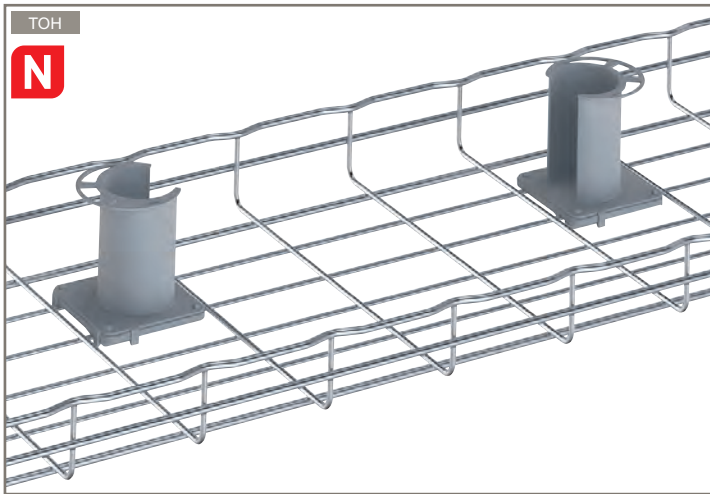

Dimensions and technical information p. 142-143

**NOTE : please use Cat. No. when placing your order**

Pack	Cat. Nos.	TOH – twist-on cable support
1	CM944707	$\updownarrow$ 30 → 150 mm $\leftarrow$ 100 → 600 mm For technical information, see p. 142

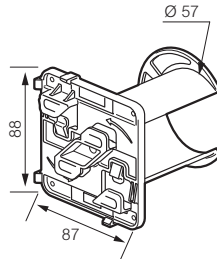

Pack	Cat. Nos.	UDO – universal dropout															
1	CM944917	$\updownarrow$ 54 → 150 mm $\leftarrow$ 100 → 600 mm For technical information, see p. 143															
1	CM944918																
1	CM944919																
1	CM944920																
		<table border="1"> <thead> <tr> <th></th> <th>L1 mm</th> <th>L2 mm</th> </tr> </thead> <tbody> <tr> <td>UDO 8</td> <td>200</td> <td>350</td> </tr> <tr> <td>UDO 12</td> <td>300</td> <td>450</td> </tr> <tr> <td>UDO 18</td> <td>450</td> <td>600</td> </tr> <tr> <td>UDO 24</td> <td>600</td> <td>750</td> </tr> </tbody> </table>		L1 mm	L2 mm	UDO 8	200	350	UDO 12	300	450	UDO 18	450	600	UDO 24	600	750
	L1 mm	L2 mm															
UDO 8	200	350															
UDO 12	300	450															
UDO 18	450	600															
UDO 24	600	750															
1	CM944975	CM945104	UDO 8	200	350												
1	CM944976	CM945105	UDO 12	300	450												
1	CM944977	–	UDO 18	450	600												
1	CM944978	–	UDO 24	600	750												

**Key:** Electrogalvanised after manufacture    Black

Plastic    White

For detailed information related to finishes, refer to p. 150-151

All dimensions (mm) are nominal