

Tino

LED

Energy-efficient, low maintenance, industrial IP44 LED allround luminaire. Wide selection of optics and power options enables use of Tino in various applications from supermarkets to logistic centers and parking halls.



Tino with clear diffuser



Helvar ActiveAhead

ActiveAhead is a self-learning, wirelessly networked and future proof control system. ActiveAhead luminaires listen and learn by themselves and from each other to make sure that there is always light on your way. Plug'n play, no programming or commissioning needed.

Optics

Ensto luminaires include variable possibilities for optical solutions to choose from. Symmetric, wide and many others, our product families have several options for light distribution and -output to fit your project and demand.

Tunable White

Ensto luminaires with Tunable White -solution are a base for Human Centric lighting. You can integrate Ensto TW -luminaires into numerous control systems which operate steplessly between 2700 K and 6500 K. Tunable White -solution is perfect for modern office use.

DALI

DALI drivers enable luminaires to be connected to DALI based control systems and Smart Buildings. Compared to a fixed output installation, the dimming and individual control capability provided by DALI enables considerable energy savings and control, depending on luminaire specifications.



“Versatile power pack for industrial and market use.”



Tino with frosted acrylic diffuser



Tino ActiveAhead IP21



Tino ActiveAhead IP44

Structure

- ▶ Body aluminium profile, end caps aluminium, colour white
- ▶ Diffuser clear (C) or frosted (F) acrylic
- ▶ Optics:
 - Wide beam (WB)
 - Medium beam (MB)
- ▶ DALI, ActiveAhead and basic models
- ▶ TN2xxx models:
 - Connected load 41W, length 880 mm
 - Connected load 54W, length 1160 mm
 - Connected load 66W, length 1440 mm
 - See the luminaire luminous flux from the table below
- ▶ TN3xxx models:
 - 1-row model
 - Frosted (F) acrylic models
 - Lengths: 880 mm, 1160 mm and 1440 mm
 - See the luminaire luminous flux from the table below
- ▶ Tino ActiveAhead -models:
 - AA-models IP-class IP44
 - AA21-models IP-class IP21
 - ▶ 4000 K, power factor 0,98, Ra> 80
 - ▶ Ambient temperature – 20 °C - + 30 °C
 - ▶ LED module lifespan $T_a=25\text{ °C}$:
 - >100 000 h (L70)
 - 100 000 h (L80)
 - 71 000 h (L90)
 - ▶ LED driver lifetime $T_a=25\text{ °C}$:
 - 100 000 h (max. 10 % failure rate)

Mounting

- ▶ Directly to the ceiling with AMJK1 spring brackets (included in the delivery)
- ▶ To the lighting suspension rail (MEK) with AMJK2 spring brackets
- ▶ Through-wired -o-o- 5 x 2,5 mm², controlled models 1-phase for through-wiring
- ▶ ActiveAhead-models ended installation

Made to order

- ▶ With connection lead
- ▶ With asymmetrical light distribution, light distribution curves when requested (excl. TN3-models)
- ▶ Product codes as Tino G2-basic models, but however the 4. character is 1 (e.g. TN2134WBF)
- ▶ RA > 90-models made to order, luminous flux is ca. 15% lower than in Ra >80-models
- ▶ 3000 K -models
- ▶ With spring brackets for XYRV, OBO and Elwia MP lighting suspension rails
- ▶ Optimized luminous flux versions to projects

| E number | Type | Product name | Output | Kg | Length | Light distribution | Control | Luminous flux |
|--|---------------|------------------------------------|--------|-----|--------|--------------------|-------------|---------------|
| ActiveAhead, wide beam optics, frosted diffuser | | | | | | | | |
| 43 606 70 | TN3134WBFAA | TN3134WBFAA LED IP44 41W/840 ACF | 41W | 1,9 | 955 | WBF | ActiveAhead | 5240 lm |
| 43 606 71 | TN3144WBFAA | TN3144WBFAA LED IP44 53W/840 ACF | 53W | 2,5 | 1235 | WBF | ActiveAhead | 7500 lm |
| 43 606 73 | TN3154WBFAA | TN3154WBFAA LED IP44 65W/840 ACF | 65W | 3,1 | 1515 | WBF | ActiveAhead | 9260 lm |
| 43 604 56 | TN3134WBFAA21 | TN3134WBFAA21 LED IP21 41W/840 ACF | 41W | 1,8 | 910 | WBF | ActiveAhead | 5240 lm |
| 43 604 59 | TN3144WBFAA21 | TN3144WBFAA21 LED IP21 53W/840 ACF | 53W | 2,4 | 1190 | WBF | ActiveAhead | 7500 lm |
| 43 604 86 | TN3154WBFAA21 | TN3154WBFAA21 LED IP21 65W/840 ACF | 65W | 3,0 | 1470 | WBF | ActiveAhead | 9260 lm |
| ActiveAhead, medium beam optics, frosted diffuser | | | | | | | | |
| 43 604 89 | TN3134MBFAA | TN3134MBFAA LED IP44 41W/840 ACF | 41W | 1,9 | 955 | MBF | ActiveAhead | 5220 lm |
| 43 605 44 | TN3144MBFAA | TN3144MBFAA LED IP44 53W/840 ACF | 53W | 2,5 | 1235 | MBF | ActiveAhead | 7480 lm |
| 43 605 54 | TN3154MBFAA | TN3154MBFAA LED IP44 65W/840 ACF | 65W | 3,1 | 1515 | MBF | ActiveAhead | 9210 lm |
| 43 606 74 | TN3134MBFAA21 | TN3134MBFAA21 LED IP21 41W/840 ACF | 41W | 1,8 | 910 | MBF | ActiveAhead | 5220 lm |
| 43 606 76 | TN3144MBFAA21 | TN3144MBFAA21 LED IP21 53W/840 ACF | 53W | 2,4 | 1190 | MBF | ActiveAhead | 7480 lm |
| 43 606 79 | TN3154MBFAA21 | TN3154MBFAA21 LED IP21 65W/840 ACF | 65W | 3,0 | 1470 | MBF | ActiveAhead | 9210 lm |
| With wide beam optics, clear diffuser | | | | | | | | |
| 43 603 92 | TN2234WBC | TN2234WBC LED IP44 41W/840 ACC | 41W | 1,8 | 880 | WBC | | 6003 lm |
| 43 603 94 | TN2234WBCED | TN2234WBCED 41W/840 AC C DALI | 41W | 1,8 | 880 | WBC | DALI | 6003 lm |
| 43 604 07 | TN2244WBC | TN2244WBC LED IP44 54W/840 ACC | 54W | 2,4 | 1160 | WBC | | 7936 lm |
| 43 604 09 | TN2244WBCED | TN2244WBCED 54W/840 AC C DALI | 54W | 2,4 | 1160 | WBC | DALI | 7936 lm |
| 43 604 22 | TN2254WBC | TN2254WBC LED IP44 66W/840 ACC | 66W | 3,0 | 1440 | WBC | | 10057 lm |
| 43 604 25 | TN2254WBCED | TN2254WBCED 66W/840 AC C DALI | 66W | 3,0 | 1440 | WBC | DALI | 10057 lm |



| E number | Type | Product name | Output | Kg | Length | Light distribution | Control | Luminous flux |
|--|----------------|--|--------|-----|--------|--------------------|---------|---------------|
| With wide beam optics, frosted diffuser | | | | | | | | |
| 43 605 96 | TN3134WBF | TN3134WBF LED IP44 41W/840 ACF | 41W | 1,8 | 880 | WBF | | 5240 lm |
| 43 605 98 | TN3134WBFED | TN3134WBFED LED IP44 41W/840 ACF DALI | 41W | 1,8 | 880 | WBF | DALI | 5240 lm |
| 43 603 97 | TN2234WBF | TN2234WBF LED IP44 41W/840 ACF | 41W | 1,8 | 880 | WBF | | 5904 lm |
| 43 603 98 | TN2234WBFED | TN2234WBFED 41W/840 AC F DALI | 41W | 1,8 | 880 | WBF | DALI | 5904 lm |
| 43 606 02 | TN3144WBF | TN3144WBF LED IP44 53W/840 ACF | 53W | 2,4 | 1160 | WBF | | 7500 lm |
| 43 606 04 | TN3144WBFED | TN3144WBFED LED IP44 53W/840 ACF DALI | 53W | 2,4 | 1160 | WBF | DALI | 7500 lm |
| 43 604 12 | TN2244WBF | TN2244WBF LED IP44 54W/840 ACF | 54W | 2,4 | 1160 | WBF | | 7880 lm |
| 43 604 13 | TN2244WBFED | TN2244WBFED 54W/840 AC F DALI | 54W | 2,4 | 1160 | WBF | DALI | 7880 lm |
| 43 606 08 | TN3154WBF | TN3154WBF LED IP44 65W/840 ACF | 65W | 3,0 | 1440 | WBF | | 9260 lm |
| 43 606 10 | TN3154WBFED | TN3154WBFED LED IP44 65W/840 ACF DALI | 65W | 3,0 | 1440 | WBF | DALI | 9260 lm |
| 43 604 30 | TN2254WBF | TN2254WBF LED IP44 66W/840 ACF | 66W | 3,0 | 1440 | WBF | | 9885 lm |
| 43 604 31 | TN2254WBFED | TN2254WBFED 66W/840 AC F DALI | 66W | 3,0 | 1440 | WBF | DALI | 9885 lm |
| With wide beam optics, frosted diffuser, lumen packages | | | | | | | | |
| 43 613 45 | TN3134WBF40 | TN3134WBF40 LED IP44 33W/840 ACF | 33W | 1,8 | 880 | WBF | | 4200 lm |
| 43 613 46 | TN3134WBFED40 | TN3134WBFED40 LED IP44 33W/840 ACF DALI | 33W | 1,8 | 880 | WBF | DALI | 4200 lm |
| 43 605 58 | TN3144WBF40 | TN3144WBF40 LED IP44 26W/840 ACF | 26W | 2,4 | 1160 | WBF | | 4200 lm |
| 43 606 00 | TN3144WBF40ED | TN3144WBF40ED LED IP44 26W/840 ACF DALI | 26W | 2,4 | 1160 | WBF | DALI | 4200 lm |
| 43 605 61 | TN3144WBF50 | TN3144WBF50 LED IP44 32W/840 ACF | 32W | 2,4 | 1160 | WBF | | 5100 lm |
| 43 606 03 | TN3144WBF50ED | TN3144WBF50ED LED IP44 32W/840 ACF DALI | 32W | 2,4 | 1160 | WBF | DALI | 5100 lm |
| 43 605 64 | TN3144WBF60 | TN3144WBF60 LED IP44 39W/840 ACF | 39W | 2,4 | 1160 | WBF | | 6100 lm |
| 43 606 06 | TN3144WBF60ED | TN3144WBF60ED LED IP44 39W/840 ACF DALI | 39W | 2,4 | 1160 | WBF | DALI | 6100 lm |
| 43 605 67 | TN3154WBF100 | TN3154WBF100 LED IP44 69W/840 ACF | 69W | 3,0 | 1440 | WBF | | 10 000 lm |
| 43 606 09 | TN3154WBF100ED | TN3154WBF100ED LED IP44 69W/840 ACF DALI | 69W | 3,0 | 1440 | WBF | DALI | 10 000 lm |
| With medium beam optics, clear diffuser | | | | | | | | |
| 43 603 86 | TN2234MBC | TN2234MBC LED IP44 41W/840 ACC | 41W | 1,8 | 880 | MBC | | 5841 lm |
| 43 603 88 | TN2234MBCED | TN2234MBCED 41W/840 AC C DALI | 41W | 1,8 | 880 | MBC | DALI | 5841 lm |
| 43 604 01 | TN2244MBC | TN2244MBC LED IP44 54W/840 ACC | 54W | 2,4 | 1160 | MBC | | 7812 lm |
| 43 604 03 | TN2244MBCED | TN2244MBCED 54W/840 ACC DALI | 54W | 2,4 | 1160 | MBC | DALI | 7812 lm |
| 43 604 16 | TN2254MBC | TN2254MBC LED IP44 66W/840 ACC | 66W | 3,0 | 1440 | MBC | | 9826 lm |
| 43 604 18 | TN2254MBCED | TN2254MBCED 66W/840 AC C DALI | 66W | 3,0 | 1440 | MBC | DALI | 9826 lm |
| With medium beam optics, frosted diffuser | | | | | | | | |
| 43 605 93 | TN3134MBF | TN3134MBF LED IP44 41W/840 ACF | 41W | 1,8 | 880 | MBF | | 5220 lm |
| 43 605 95 | TN3134MBFED | TN3134MBFED LED IP44 41W/840 ACF DALI | 41W | 1,8 | 880 | MBF | DALI | 5220 lm |
| 43 603 89 | TN2234MBF | TN2234MBF LED IP44 41W/840 ACF | 41W | 1,8 | 880 | MBF | | 5845 lm |
| 43 603 91 | TN2234MBFED | TN2234MBFED 41W/840 AC F DALI | 41W | 1,8 | 880 | MBF | DALI | 5845 lm |
| 43 605 99 | TN3144MBF | TN3144MBF LED IP44 53W/840 ACF | 53W | 2,4 | 1160 | MBF | | 7480 lm |
| 43 606 01 | TN3144MBFED | TN3144MBFED LED IP44 53W/840 ACF DALI | 53W | 2,4 | 1160 | MBF | DALI | 7480 lm |
| 43 604 04 | TN2244MBF | TN2244MBF LED IP44 54W/840 ACF | 54W | 2,4 | 1160 | MBF | | 7777 lm |
| 43 604 06 | TN2244MBFED | TN2244MBFED 54W/840 AC F DALI | 54W | 2,4 | 1160 | MBF | DALI | 7777 lm |
| 43 606 05 | TN3154MBF | TN3154MBF LED IP44 65W/840 ACF | 65W | 3,0 | 1440 | MBF | | 9210 lm |
| 43 606 07 | TN3154MBFED | TN3154MBFED LED IP44 65W/840 ACF DALI | 65W | 3,0 | 1440 | MBF | DALI | 9210 lm |
| 43 604 19 | TN2254MBF | TN2254MBF LED IP44 66W/840 ACF | 66W | 3,0 | 1440 | MBF | | 9775 lm |
| 43 604 21 | TN2254MBFED | TN2254MBFED 66W/840 AC F DALI | 66W | 3,0 | 1440 | MBF | DALI | 9775 lm |
| With medium beam optics, frosted diffuser, lumen packages | | | | | | | | |
| 43 613 43 | TN3134MBF40 | TN3134MBF40 LED IP44 33W/840 ACF | 33W | 1,8 | 880 | MBF | | 4200 lm |
| 43 613 44 | TN3134MBFED40 | TN3134MBFED40 LED IP44 33W/840 ACF DALI | 33W | 1,8 | 880 | MBF | DALI | 4200 lm |
| 43 605 70 | TN3144MBF40 | TN3144MBF40 LED IP44 26W/840 ACF | 26W | 2,4 | 1160 | MBF | | 4200 lm |
| 43 606 12 | TN3144MBF40ED | TN3144MBF40ED LED IP44 26W/840 ACF DALI | 26W | 2,4 | 1160 | MBF | DALI | 4200 lm |
| 43 605 73 | TN3144MBF50 | TN3144MBF50 LED IP44 32W/840 ACF | 32W | 2,4 | 1160 | MBF | | 5000 lm |
| 43 606 15 | TN3144MBF50ED | TN3144MBF50ED LED IP44 32W/840 ACF DALI | 32W | 2,4 | 1160 | MBF | DALI | 5000 lm |
| 43 605 76 | TN3144MBF60 | TN3144MBF60 LED IP44 39W/840 ACF | 39W | 2,4 | 1160 | MBF | | 6400 lm |
| 43 606 18 | TN3144MBF60ED | TN3144MBF60ED LED IP44 39W/840 ACF DALI | 39W | 2,4 | 1160 | MBF | DALI | 6400 lm |
| 43 605 79 | TN3154MBF100 | TN3154MBF100 LED IP44 69W/840 ACF | 69W | 3,0 | 1440 | MBF | | 10 000 lm |
| 43 606 21 | TN3154MBF100ED | TN3154MBF100ED LED IP44 69W/840 ACF DALI | 69W | 3,0 | 1440 | MBF | DALI | 10 000 lm |

| E number | Type | Product name | Output | Kg | Length | Light distribution | Control | Luminous flux |
|-----------------------------|--------|-----------------------------------|---|----|--------|--------------------|---------|---------------|
| Mounting accessories | | | | | | | | |
| 43 641 70 | AMJK1 | AMJK1 SPRING BRACKET PAIR | Spring bracket pair | | | | | |
| 43 641 72 | AMJK2 | AMJK2 SPRING BRACKET PAIR | Spring bracket pair for suspension rail mounting, rail width 70 mm | | | | | |
| 42 653 82 | AMJK2V | AMJK2V SPRING BRACKET PAIR, WHITE | Spring bracket pair for suspension rail mounting, rail width 70 mm | | | | | |
| 42 653 05 | AMJK3 | AMJK3 SPRING BRACKET PAIR | Spring bracket pair for suspension rail mounting, rail width 110 mm | | | | | |
| 43 600 83 | AMJK3V | AMJK3V SPRING BRACKET PAIR, WHITE | Spring bracket pair for suspension rail mounting, rail width 110 mm | | | | | |
| 43 614 41 | AMJKSH | AMJK SUSPENSION HOOK KIT | Suspension hook kit | | | | | |

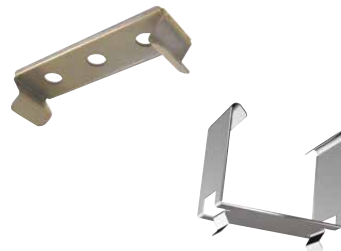
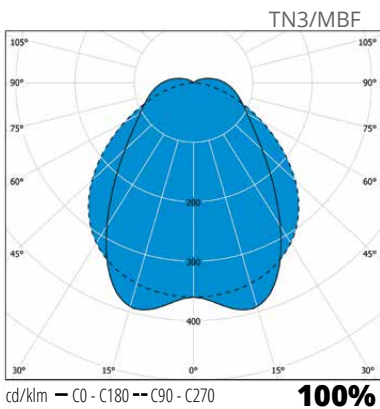
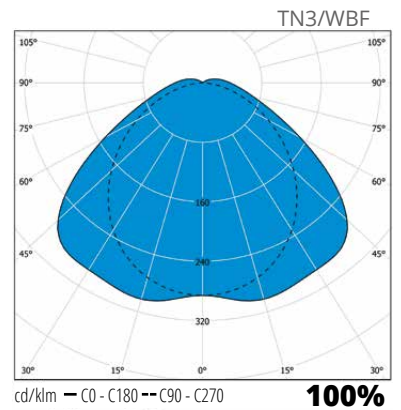
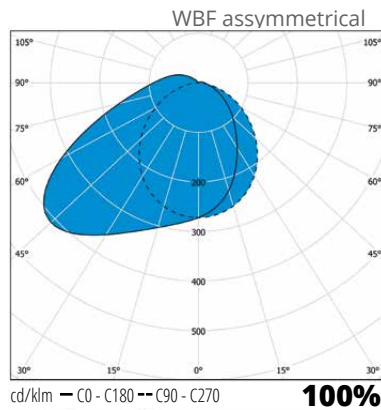
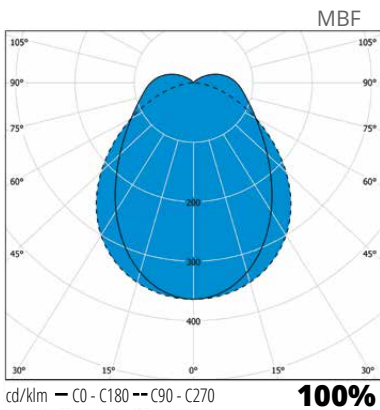
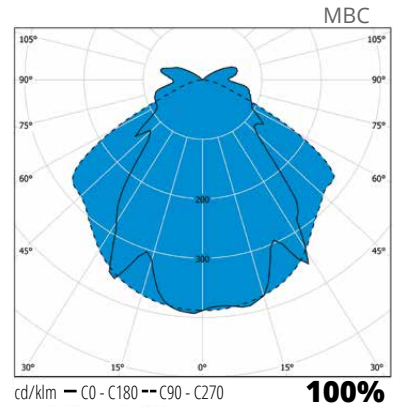
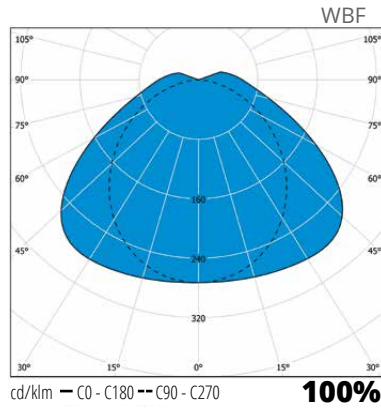
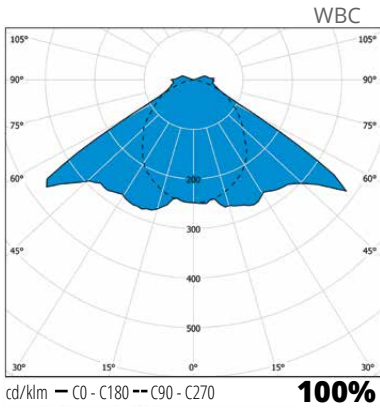

Spring brackets AMJK1 and AMJK2

