

# Aino

LED

Aino is an elegant and stylishly radiant LED luminaire for public premises. Luminaire can be surface or suspension mounted. It can be used in various applications like offices, corridors and entrances.

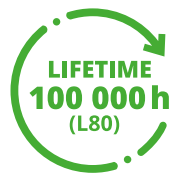

## Optics

Ensto luminaires include variable possibilities for optical solutions to choose from. Symmetric, wide and many others, our product families have several options for light distribution and -output to fit your project and demand.

## DALI

DALI drivers enable luminaires to be connected to DALI based control systems and Smart Buildings. Compared to a fixed output installation, the dimming and individual control capability provided by DALI enables considerable energy savings and control, depending on luminaire specifications.

## Dimming

Ensto can provide many dimming possibilities for luminaires. 1-10V, Switch Dim, DALI and base light are just few examples of possibilities to change the light output to fit your premises.



"Light and beautiful office fixture to support general lighting."



AIL14493

### Structure

- › Body - white (RAL 9016) coated aluminium profile, grey AIH-models (RAL 9006) to be ordered separately
- › Diffuser - ribbed frosted acrylate (93)
- › Models:  
Direct down light models  
Direct/indirect light models (Y), ca. 20% (LED), dust cover for the upright openings - clear acrylate plate
- › LED down light models with frosted acrylate diffuser:  
Connected load and luminaire luminous flux, see table  
4000 K, Ra > 80, power factor 0,98 and 0,90 (DALI)  
Ambient temperature - 20 °C - + 30 °C
- › LED module lifespan  $T_a=25$  °C:  
>100 000 h (L70)  
100 000 h (L80)  
71 000 h (L90)
- › LED driver lifetime  $T_a=25$  °C:  
100 000 h (max. 10 % failure rate)

### Control

- › DALI (ED)

### Mounting

- › Wire suspension
- › Directly to the ceiling or on a lighting suspension rail with spring brackets included to the delivery. Please note! The connections inside the luminaire has to be done before installing the luminaire to the ceiling or to the lighting suspension rail.
- › -o- 3x1,5 mm<sup>2</sup> or 5x1,5 mm<sup>2</sup> (DALI), connection point at the end of the luminaire
- › AIRK-ramp mountind sets for direct or 90° ramp installation. Sets include an extension piece and fixing screws.
- › Mounting accessories to be ordered separately

### Made to order

- › With pull cord switch, with connection lead
- › Ramp models
- › With grey colour (RAL 9006)
- › With luminaire integrated sensors. Check sensor specific availability from the product management.

E number	Type	Product name	Output	Base	Kg	A	E	Luminous flux	Control
<b>Aino LED down light models - with frosted diffuser (93)</b>									
42 606 66	AIL14493	AIL14493 LED 22W/840 AC F	22W	LED	3,3	1170	948	2512 lm	
42 606 67	AIL14493ED	AIL14493ED LED 22W/840 AC F DA	22W	LED	3,3	1170	948	2512 lm	DALI
42 606 72	AIL15493	AIL15493 LED 26W/840 AC F	26W	LED	4,1	1450	1228	3007 lm	
42 606 73	AIL15493ED	AIL15493ED LED 26W/840 AC F DA	26W	LED	4,1	1450	1228	3007 lm	DALI
<b>Aino LED direct/indirect light models (Y), upright ca. 20 % - with frosted diffuser (93)</b>									
42 606 69	AIL14493Y	AIL14493Y LED 27W/840 AC F	27W	LED	3,3	1170	948	3140 lm	
42 606 70	AIL14493YED	AIL14493YED LED 27W/840 AC DA	27W	LED	3,3	1170	948	3140 lm	DALI
42 606 75	AIL15493Y	AIL15493Y LED 30W/840 AC F	30W	LED	4,1	1450	1228	3643 lm	
42 606 76	AIL15493YED	AIL15493YED LED 30W/840 AC DA	30W	LED	4,1	1450	1228	3643 lm	DALI
<b>Aino mounting accessories</b>									
42 603 78	RVLX04	RVLX04 WIRE SUSP.SET 1.5M Ø31	susp. wire set 1,5 m with friction locks, diameter of the ceiling cup ø 31 mm						
42 605 54	AIRK	AIRK RAMP MOUNT. SET DIRECT	extension piece direct						
42 605 65	AIRKL90	AIRKL90 RAMP MOUNT. SET 90 DEGREES LEFT	angle extension piece left						
42 605 79	AIRKR90	AIRKR90 RAMP MOUNT. SET 90 DEGREES RIGHT	angle extension piece right						

LED down light models, frosted diffuser

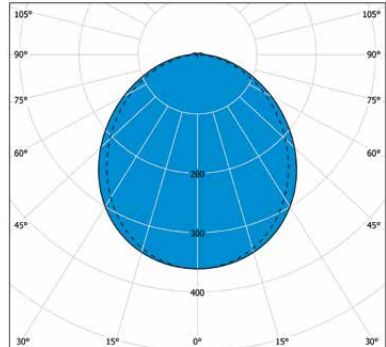

cd/klm — C0 - C180 — C90 - C270 **100%**

LED direct/indirect light models, frosted diffuser

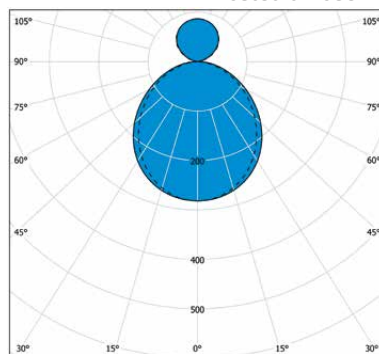

cd/klm — C0 - C180 — C90 - C270 **100%**

Luminaires per miniature circuit breaker B10 B16 C10 C16

Luminaires per miniature circuit breaker	B10	B16	C10	C16
AIL...	22	36	37	61
AIL...ED	22	36	37	61

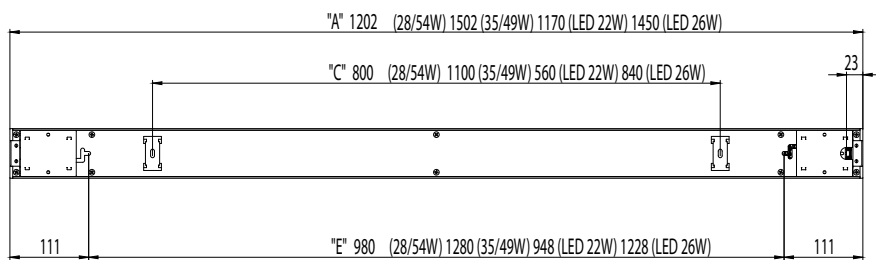

Aino with down light

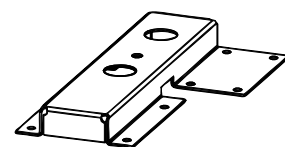
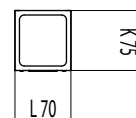

AIRKR90 right

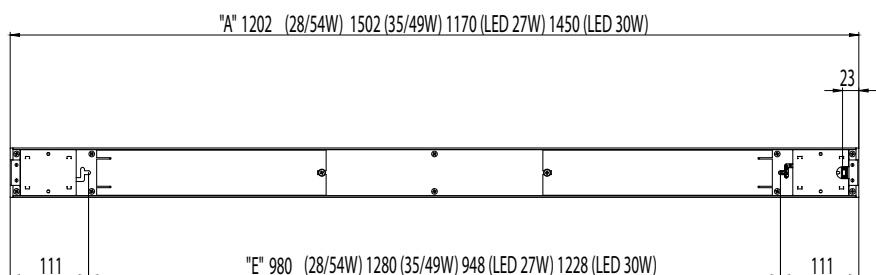

Aino with direct/indirect light

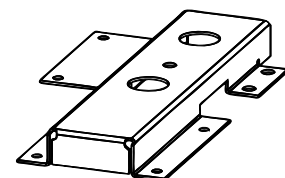
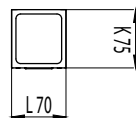

AIRKL90 left

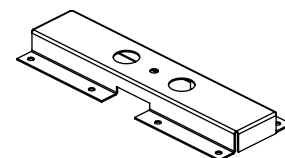

AIRK direct



Aino fits into many spaces and purposes. There are many installation options and a wide range.