

Metal cable glands IP 68

ISO and PG



0 955 05



0 955 09



0 955 16

Pack	Cat.Nos	Metal cable glands
------	---------	--------------------

Mechanically tightened cable glands with neoprene weatherproof seal for IP 68 protection. Locking part consisting of flexible blades which exert strong pressure on the cable thus giving the product excellent tensile strength
Supplied with surface seal mounted

ISO

Conform to EN 50262

Pack	Cat.Nos	ISO	Clamping capacity	
			Ø Min. (mm)	Ø Max. (mm)
20	0 955 01	16	5.5	9.5
20	0 955 03	20	7	13
10	0 955 05	25	8	16
5	0 955 06	32	11	21
5	0 955 07	40	15	27
2	0 955 08	50	22	35
2	0 955 09	63	35	48

PG

Conform to UTE C 68-300 and 68-312 guides recommendations

Pack	Cat.Nos	PG	Clamping capacity	
			Ø Min. (mm)	Ø Max. (mm)
20	0 955 10	7	3	6.5
20	0 955 11	9	4	9
20	0 955 12	11	6	11.5
20	0 955 13	13.5	7	13
20	0 955 14	16	10	15
10	0 955 15	21	11	19
10	0 955 16	29	16	26
10	0 955 17	36	22	34.5
2	0 955 18	42	27	40
2	0 955 19	48 DIN	35	48

Metal locking nuts

ISO

50	3 866 31	ISO 16
50	3 866 32	ISO 20
50	3 866 33	ISO 25
50	3 866 34	ISO 32
25	3 866 35	ISO 40
10	3 866 36	ISO 50
10	3 866 37	ISO 63

PG

50	3 866 21	PG 7
50	3 866 22	PG 9
50	3 866 23	PG 11
50	3 866 24	PG 13.5
50	3 866 25	PG 16
50	3 866 26	PG 21
25	3 866 27	PG 29
25	3 866 28	PG 36
10	3 866 29	PG 42
10	3 866 30	PG 48

Metal cable glands IP 68

Cable glands

Characteristics

Nickel-plated brass (locking part in polyamide)
Operating temperature: - 25 °C + 85 °C

Dimensions (mm)

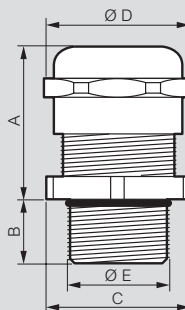

Cat.Nos	Threading	A max.	B	Ø D	C (to flat)	Ø E	Drilling Ø
0 955 01	ISO 16	25	5	19	17	15.9	16.2
0 955 03	ISO 20	27	6	24	22	19.8	20.4
0 955 05	ISO 25	27	7	30	27	24.6	25.4
0 955 06	ISO 32	31	8	36	34	31.6	32.5
0 955 07	ISO 40	34	8	46	42	39.7	40.5
0 955 08	ISO 50	37	9	60	55	49.7	50.8
0 955 09	ISO 63	45	10	70	65	62.6	64

Cat.Nos	Threading	A max.	B	Ø D	C (to flat)	Ø E	Drilling Ø
0 955 10	PG 7	21	5	15.6	14	12.4	12.7
0 955 11	PG 9	25	6	19	17	15.1	15.2
0 955 12	PG 11	25	6	22	20	18.4	18.6
0 955 13	PG 13.5	26	6.5	24	22	20.3	20.4
0 955 14	PG 16	28	6.5	26.6	24	22.4	22.5
0 955 15	PG 21	32	7	33	30	27.7	28.3
0 955 16	PG 29	36	8	44	40	36.9	37
0 955 17	PG 36	39	9	55.6	50	46.9	47
0 955 18	PG 42	42	10	63	58	54	54
0 955 19	PG 48	44	10	69.5	65	60	60

Locking nuts

Nickel-plated brass

Dimensions (mm)

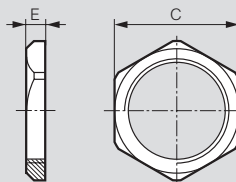

ISO

Cat.Nos	Threading	C	E
3 866 31	ISO 16	19	3
3 866 32	ISO 20	24	3.5
3 866 33	ISO 25	30	4
3 866 34	ISO 32	36	4
3 866 35	ISO 40	46	5
3 866 36	ISO 50	60	5
3 866 37	ISO 63	70	6

PG

Cat.Nos	Threading	C	E
3 866 21	PG 7	15	2.8
3 866 22	PG 9	18	2.8
3 866 23	PG 11	21	3
3 866 24	PG 13.5	23	3
3 866 25	PG 16	26	3
3 866 26	PG 21	32	3.5
3 866 27	PG 29	41	4
3 866 28	PG 36	51	5
3 866 29	PG 42	60	6
3 866 30	PG 48	65	6.5